

+ LOWER LEVEL

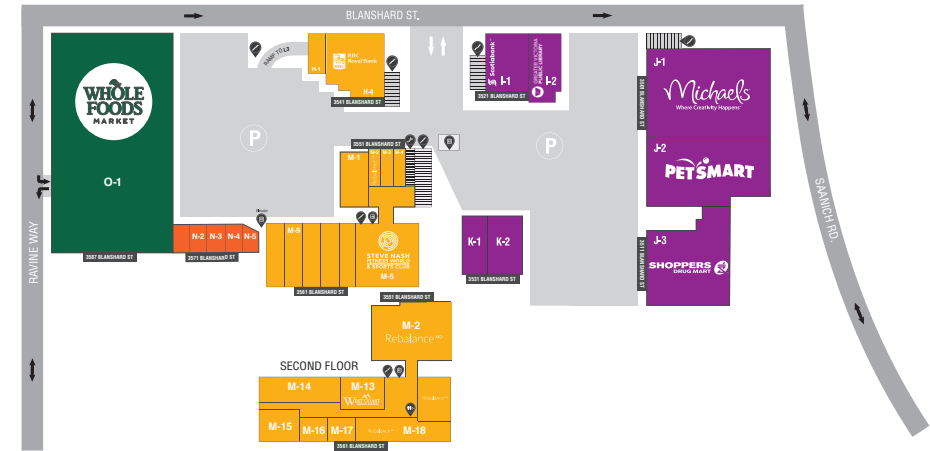

+ UPPER LEVEL



+ STORE DIRECTORY

**ANCHORS**

- D-3** Best Buy
- J-1** Michaels
- J-2** PetSmart
- J-3** Shoppers Drug Mart
- B-1** Walmart
- O-1** Whole Foods Market

**FASHION**

- A-7** Amelia Lee Boutique
- C-5** Chai Fashions
- C-1** Dynamite / Garage
- G-9** Endür
- F-4** H&M
- C-4** Laura
- A-5** Meraki
- B-8** Modern Baby
- K-1** Moores Clothing For Men
- D-2** Optiks International
- B-6** Plenty
- F-6** Plenty Men's
- A-8** Premium Label
- F-5** Suzy Shier
- C-7** The Children's Place
- A-6** The North Face

**FOOTWEAR**

- A-3** A Step Ahead Footwear
- E-4** Famous Footwear
- A-5** Meraki
- B-6** Plenty
- F-6** Plenty Men's
- E-1** Quarks - *coming soon*

**BEAUTY & SPA**

- N-2** Blush Nail Spa
- G-5** Ecotique Salon & Spa
- G-3** Foxy Box - *coming soon*
- C-2** Salon Felice Aveda Salon & Spa
- N-2** Taylor & Colt Barber Spa
- C-6** The Green Kiss
- E-11** Urban Nail Spa
- G-6** Zennkai Salon

**FOOD & GOURMET SPECIALTY**

- G-1** Browns Socialhouse
- A-1** Cascadia Liquor Store
- A-4** Dynamite Donuts - *coming soon*
- B-3** Davids Tea
- C-9** Erito Sushi
- O-1** Fin & Pearl
- D-1** Good Earth Coffeehouse
- B-1** McDonalds
- A-13** Mr. Pretzels
- H-1** Mucho Burrito
- A-12** Puerto Vallarta Amigos
- C-10** Qoola Frozen Yogurt & Fruit Bar
- B-4** Rogers' Chocolate
- F-8** Sizzling Tandoor Restaurant
- B-5** Starbucks
- E-12** The Chopped Leaf
- A-2** The Cookie Guy
- E-10** The Noodle Box

**HOME**

- A-7** Amelia Lee Boutique
- M-9** Parc Modern Home
- D-7** Urban Barn

**FINANCIAL**

- C-11** DLC Modern Mortgage Group
- E-3** HSBC
- K-2** Megson FitzPatrick Insurance Services
- H-2** RBC
- I-1** Scotiabank
- B-1** Sussex Insurance
- G-2** Westland Insurance

**JEWELRY**

- B-7** PACHULAH

**CELLULAR**

- E-7** Bell
- B-9** Black Apple Cellular
- D-6** Freedom Mobile
- C-8** Rogers Mobility
- E-6** Telus Mobility

**MEDICAL**

- M-14** Dr. Bernstein Diet & Health Clinic
- M-15** Dr. Erasmus Victoria Retina
- G-7** Orthodontics Victoria
- M-2** ReBalance MD Main Entrance
- M-2** ReBalance MD Annex
- M-18** Rebalance MD South Wing
- D-5** Smile Esthetics
- C-11** Uptown Dental Centre
- B-1** Uptown Medical Clinic
- D-2** Uptown Village Optometry
- M-16** Victoria Skin Cancer Screening
- M-13** West Coast Medical Imaging

**LIBRARY**

- I-2** GVPL – Emily Carr Branch

**HEALTH**

- E-5** Annex RAW
- D-5** Smile Esthetics
- G-4** Supplement King - *coming soon*

**SPECIALITY & SERVICES**

- F-9** 4Cats Art Studio
- E-9** Kids & Company
- B-1** Lotto Centre
- N-4** Maritime Travel
- D-2** Optiks International
- A-14** Pretty Please
- M-4** Shaw
- N-3** The Bone & Biscuit Co.

**PROFESSIONAL OFFICES**

- G-7/C-11** Babcock
- D-4** BC Assessment
- C-11** Blockstream
- C-11** Canada Life
- F-10** Consumer Protection
- C-11** HART Legal
- C-11** Island Savings - *coming soon*
- G-7** Municipal Finance Authority Office of BC
- M-3** Realtii Inc.
- D-4** Spaces
- M-1** The Studio Design and Marketing
- G-7** Tom Harris Cellular
- C-11** Uptown Administration Office
- F-10** WSP
- Security located in P1 blue
- EV Parking spots located in P1 blue
- Tesla Superchargers



Elevator



Stairs



Escalator



Washrooms



Guest Services,  
Community Room



UPTOWN BEAUTY • STYLE BAR